

SUPPLY OF
ALL TYPES
OF INTERIOR
AND EXTERIOR
PREFAB PRODUCTS
AND SERVICES



LIGHT WEIGHT
WALL PANELS
FOR FAST
CONSTRUCTIONS

MAHANAIM PREFABS PVT. LTD.

Shelter for all Prefab Needs & Readymade Wall Construction

Corporate Office:

No. 99/42, First Floor,
K.C. Gardens, 4th Street,
Peravallur, Chennai - 600082.
Tamil Nadu. South India.

Branch Office:

No. 7/99B, Krishnarajapuram East,
Opp. Fathima Hardware,
Tuticorin 628002.
Tamil Nadu, South India.



+91-9176429822 / 9791287878



+91-44-26714335



mahanaimpfs@gmail.com



www.mahanaimprefab.com



READYMADE WALLS

Are designed for ready-to-install application in building construction. The wall panels have a tongue and groove joining system that facilitates rapid construction with minimum effort and maximizes space utilization. Panels are made of two Fibre-Reinforced Cement facing sheets, on either sides of a lightweight concrete core. The core is made from a mix of Portland cement, binders and, a mix of siliceous and micaceous material aggregate. It's installation works efficiently and offer Speed, Safety, Strength, Sustainability and, extremely compatible with texture coating, painting, wallpaper and veneers.

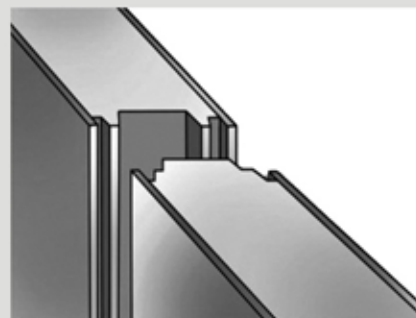

ATTRIBUTES

EASY TO INSTALL, SAVES TIME, COMPOSITE STRENGTH, ECONOMICAL

- 4 times faster than brickwork
- one forth the weight of brickwork
- robustness and strong
- fire rating more than 2 hours



Termite Resistant



Water Resistant



Sound Protection



Light Weight



Fire Resistant



Strong & Durable



Eco-Friendly



Space Saving

PANEL SIZES & WEIGHT

SIZES 600MM X 2400MM, 2700MM, 3000MM

THICKNESS & WEIGHT	50MM	56kg	63kg	70kg
	75MM	77kg	90kg	97kg

AREAS OF APPLICATION

PARTITIONS

PREFABS STRUCTURES

MEZZANINE FLOORING

CLADDING

BOUNDRY / FENCING

FIRE SEPARATION WALLS

Internal Walls: Residential / Commercial / Industrial

Pre-fabricated Shelter: Internal / External Walls

Offices, Site Offices
Shopping Malls
Educational Institutions
Hotels/ Restaurants
Housing Residential
Govt. / Defense / Army Barracks
SEZ / Industrial & Infrastructure
Manufacturing Units
Security Rooms
Warehouse / Go-downs / Storerooms
Duct Covering
Stair Case enclosures

Some of OUR WORKS



‘The God of Heaven is the one who will give us success’ - NEHEMIAH 2.20



Industrial Office Partition



Industrial Falls Ceiling



Industrial Length Wall



PreFab Wall over Mezzanie Floor



Sheet Barrcading



Corner Wall



Free Standing Wall



Internal Wall



External Prefab Construction



Finished Walls



Industrial Office Partition



Industrial Prefab Shed Work